

DRUG TESTING

Identify the Problem - Preserve the Evidence

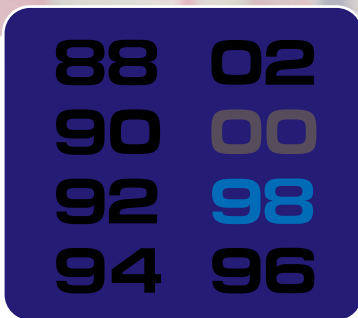

TempTrend®



StaFreez®

TempTrend® indicators are disposable liquid crystal surface temperature indicators with a temperature range of 87°F to 103°F, ideal for measuring the temperature of urine specimens for drug testing purposes.

The TempTrend® indicator is a single use monitor and can be attached to all types of urine specimen containers. It provides a single-spot reading in 1-15 seconds giving you a fast, easy method of checking urine specimen temperature.

StaFreez® indicators are an Irreversible Liquid Crystal Freeze-Thaw indicator. When frozen samples monitored with StaFreez® indicators are continuously stored at -20°C or below, the color of the activated indicator will remain dark royal blue for at least one year. If however, the frozen sample is exposed to temperatures above -20°C the indicator will change color. After the dark royal blue color of the activated StaFreez® indicator begins changing, exposing the sample to a lower temperature will not restore the indicator to its original color.



DIRECTIONS FOR USE

TempTrend® Indicator

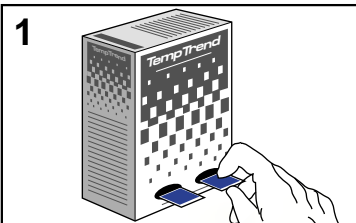

1- Pull strip from box. Tear off individual TempTrend® indicator at perforation. The unused indicators may be stored at room temperature.



2- Remove the TempTrend® indicator and peel away from the release liner.

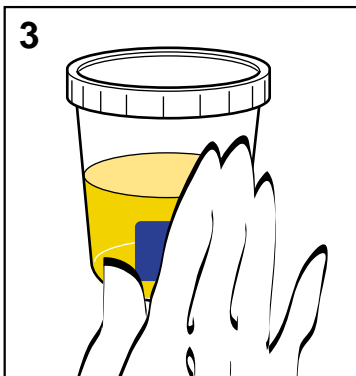

3- IMMEDIATELY press the indicator firmly and evenly onto the surface of the product. The indicator **MUST** be applied to the lower portion of the container.

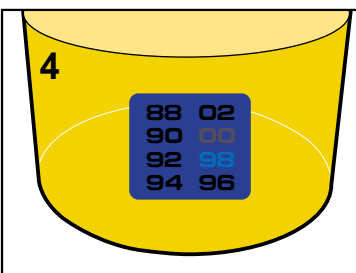

4- This reversible indicator is ideal to measure the temperature of urine as needed for drug testing validation procedures. The label provides single-spot readings in 1-15 seconds for continuous temperature trend monitoring at a glance.

The label can be attached to all types of urine specimen containers and has a temperature range of 87°-103°F.

StaFreez® Indicator

*Before placing indicator on frozen product, the indicator **MUST BE ACTIVATED**.*



1- Pull strip from box. Tear off individual StaFreez® indicator at perforation. The unused indicators may be stored at room temperature.

The frozen urine container **MUST** be -20°C (or below) before the indicator is applied. Surface of the frozen container should be free of excess oil or moisture. Wipe with cloth if necessary.

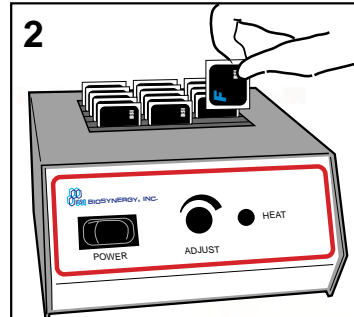

2- To **ACTIVATE** the indicator, a source of heat between 40-50°C (i.e. Biosynergy, Inc. activator) should be easily accessible. Do not use a microwave oven. For optimum results the indicator should be placed in the activator for approximately 60 seconds. The image 'F' will rapidly develop color and then turn black again.



3- Remove the StaFreez® indicator from the heat source and peel indicator away from the release liner.



4- IMMEDIATELY press the indicator firmly and evenly onto the surface of the frozen product. The indicator **MUST** be applied to the container over an area of the frozen product. Do not place it over an air pocket.

5- The irreversible indicator 'F' should be dark royal blue. If the image 'F' appears green or tan, the indicator has not been **properly activated** or the frozen material was warmer than -20°C, and the performance of the indicator will be altered. Therefore remove indicator and repeat the procedure.

